

# Studio Series

Installation Manual

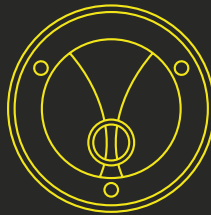

**S4-C65**

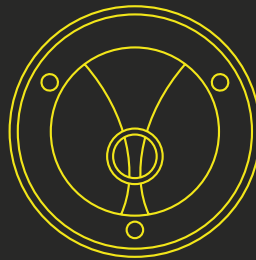

**S4-C80**

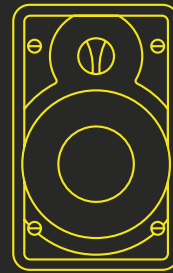

**S4-W65**

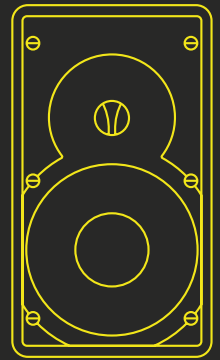

**S4-W80**

**DYNAUDIO**

**Welcome to the custom install Studio Series and thank you for choosing a Dynaudio Custom Install product. The Studio Series comprises the S4-C65 and S4-C80 in-ceiling speakers and the S4-W65 and S4-W80 in-wall speakers. Each is designed to offer high quality audio performance while at the same time incorporating features and facilities designed to ease installation.**

## 1. Introduction

This manual describes the installation of Studio Series speakers within drywall/plasterboard walls and ceilings. It begins by listing the contents of the Studio Series cartons and continues with sections that provide information common to in-ceiling and in-wall speakers. Later sections in the manual provide information specific to installing in-ceiling or in-wall speakers.

If this is your first time working with Dynaudio Studio Series custom install speakers, or if you have not done so for a while, we recommend that you read the appropriate sections of this manual before you begin.

**Note:** Visit [dynaudio.com](http://dynaudio.com) for the latest Studio Series news and information.

The Studio Series is designed to provide very high quality audio in custom installations where speakers are required to be fitted flush in walls and ceilings. The Studio Series not only benefits from four decades of Dynaudio speaker expertise but has been designed from first principles to offer a new approach to custom speaker installation and performance.

- Studio Series speakers are uniquely simple to install. Once a ceiling or wall cut-out is created, no tools are required and installation can be completed by one person without assistance. Every element of the Studio Series installation procedure, from unpacking the speakers to painting and fitting the magnetic grilles is simplified and streamlined by design.
- Studio Series speakers employ numerous Dynaudio speaker technologies, borrowed from the company's recording studio monitors and high-end hi-fi speakers, to bring genuinely high performance audio to custom installations: unique bass/mid drivers with large diameter aluminium voice coils and finite element optimised high-power, low-distortion magnet systems, proprietary MSP (Magnesium Silicate Polymer) diaphragms, and precision coated soft dome tweeters with powerful neodymium magnet systems are just a few examples among many.

### DYNAUDIO CUSTOM INSTALL LIMITED WARRANTY

Dynaudio warrants its custom install products to be free from defects in materials and workmanship under conditions of normal use and service for a lifetime period from the date of original purchase. For this warranty to apply, the unit must be installed and used according to its written instructions.

The obligation under this warranty shall be limited to the replacement, repair or refund of any such defective device within the warranty period, provided that:

1. inspection by Dynaudio indicates the validity of the claim;
2. the defect is not the result of damage, misuse, lightning, power surges, negligence, improper operation (installation) or failure to follow instructions contained in the manual or written instructions provided by Dynaudio after the original purchase;
3. the product has not been altered in any way or repaired by others and that factory sealed units are unopened (a service charge plus parts and labour will be applied to units defaced or physically damaged);
4. the dealer from whom the Dynaudio products were purchased was authorized to sell such products at the time of the original purchase;
5. the service provider for, including but not limited, installation or repair of the product, was authorized in writing by Dynaudio;
6. the original, dated Bill of Sale is presented whenever service is required during the warranty period;
7. freight charges for the return of products to Dynaudio are prepaid;
8. all units 'out of warranty' are subject to a service charge. The service charge will cover minor repairs (major repairs will be subject to additional charges for parts and labour).

This warranty is in lieu of and excludes all other warranties, expressed or implied. Neither this warranty nor any other warranty, express or implied, including implied warranties of merchantability and fitness, shall extend beyond the warranty period.

Dynaudio shall not be liable for damages to any other equipment or other items at the site of use, or any other damages whether incidental, consequential or otherwise. Dynaudio shall not be liable for any anticipated profits, any incidental or consequential damages, loss of time or other losses incurred by the purchaser in connection with the purchase, operation or use of the product.

The information this document contains is subject to change without notice. In the event that there are differences between this warranty and the provisions of any advertisements, documentation, product brochures or packaging cartons, the terms of this warranty shall prevail.

- Studio Series in-ceiling speakers incorporate 18° angled, 360° rotatable bass/mid drivers, and three position, adjustable tilt tweeters to enable their acoustic directivity to be optimised for the installation arrangement and acoustic character of the listening room.

Studio Series speakers comprise a Speaker Unit and Installation Frame. The Installation Frame is inserted into the ceiling or wall cut-out and securely fixed in place using auto-locking clamps. The Speaker Unit is then connected to the speaker cables before being inserted into the Installation Frame to be held in place by a latch system. The grille is then fitted, securely attached by magnets integrated within the Installation Frame.

1.1 Carton Contents

The carton contents for all Studio Series in-ceiling and in-wall speakers are essentially the same. Items only differ in terms of ceiling/wall format and dimension. Within each carton can be found:

- 1 x Speaker Unit
- 1 x Installation Frame
- 1 x Grille
- 1 x Cut-out Template
- 1 x Paint Mask
- 1 x Document pack

A typical carton contents is illustrated in Diagram 1.

**Note:** Square grilles are optionally available for Studio Series in-ceiling speakers. Contact Dynaudio directly or your local retailer/distributor for more information.

Environmental Note

*This product complies with international directives, including but not limited to the Restriction of Hazardous Substances (RoHS) in electrical and electronic equipment, the Registration, Evaluation, Authorisation and restriction of Chemicals (REACH) and the disposal of Waste Electrical and Electronic Equipment (WEEE). Consult your local waste disposal authority for guidance on how properly to recycle or dispose of this product.*

Disposal

*Disposal of used electrical and electronic equipment (applicable in European countries with separate collection systems for this equipment).*

*This symbol on the product or its packaging indicates that the product may not be treated as household waste. Instead it must be handed over to the applicable collection point for the recycling of electrical and electronic equipment. By ensuring this product is disposed of correctly, you will help prevent potential negative consequences for the environment and human health. The recycling of materials helps to conserve natural resources. For more detailed information on recycling this product, please contact your local authority, community waste disposal of, or the shop where you purchased the product.*



Diagram 1

Speaker Unit



Grille



Paint Mask



Installation Frame



Cut-out Template

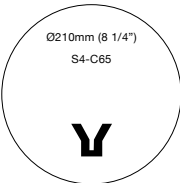

Document Pack

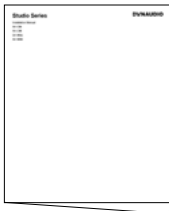

**Note:** Diagram illustrates in-ceiling speaker pack contents. In-wall pack contents are equivalent.

2. Preparation

2.1 Dimensions

Each Studio Series speaker requires specific ceiling or wall cut-out dimensions, mounting depth space and drywall (plasterboard) thickness constraints. These dimensions are tabulated and illustrated in Diagram 2.

Model	Cut-out size	Minimum Clear Depth	Drywall (Plasterboard) thickness
S4-C65	210 mm (8.25 in)	152 mm (6.00 in)	X = 38 mm max / 7.8 mm min 1.50 in max / 0.31 in min
S4-C80	260 mm (10.25 in)	161 mm (6.33 in)	X = 47.5 mm max / 7.5 mm min 1.87 in max / 0.29 in min
S4-W65	175 mm x 275 mm (6.90 in x 10.83 in)	89 mm (3.50 in)	X = 33.75 mm max / 6.75 mm min 1.33 in max / 0.27 in min
S4-W80	215 mm x 370 mm (8.25 in x 14.38 in)	96 mm (3.80 in)	X = 37.5 max / 8.5 mm min 1.48 in max / 0.33 in min

Diagram 2

S4-C65

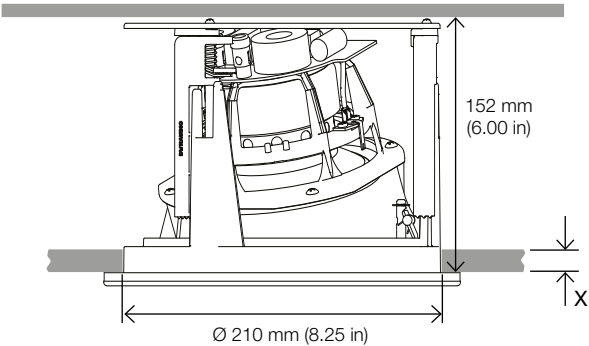

S4-C80

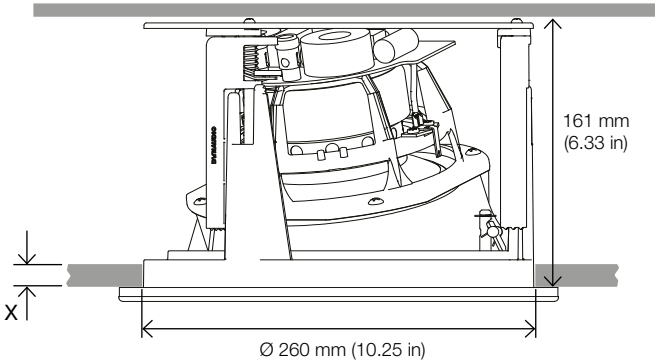

S4-W65

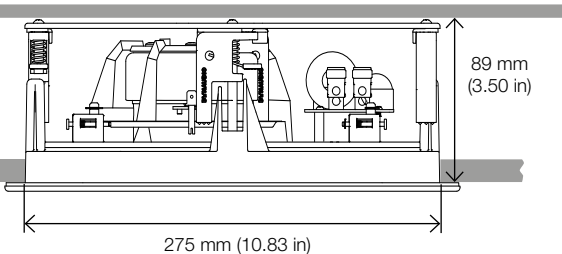
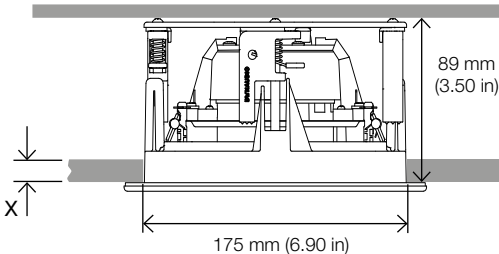
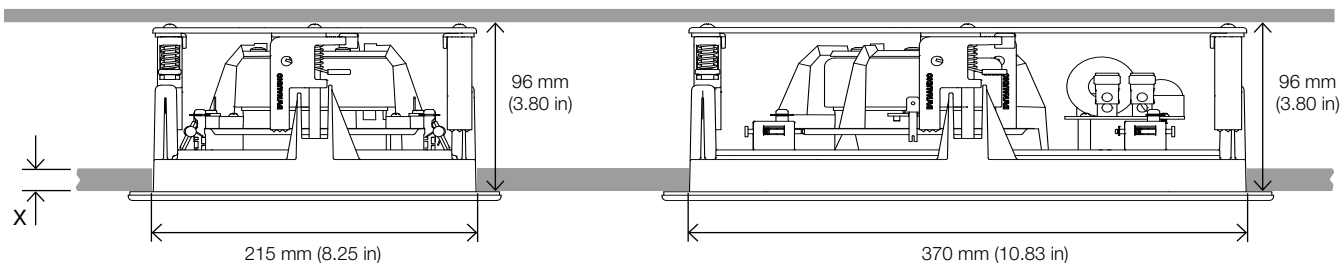

Diagram 2

S4-W80



## 2.2 Back Boxes

Studio Series speakers can be installed with back boxes in order to reduce sound transmission into adjacent rooms or to satisfy any local statutory building regulations. If back boxes are to be used they must be installed within the walls and ceilings before the drywall (plasterboard) is affixed to the studs or joists. Alternatively, the existing drywall (plasterboard) around each speaker installation position may be removed to enable a back box to be installed, and reinstated following back box installation. Further information on Dynaudio back boxes can be found at [dynaudio.com](http://dynaudio.com).

Generic back boxes from alternative manufacturers can be used, or back boxes may be constructed on site. In either case, Studio Series speakers require a 22 Litre (0.8 ft<sup>3</sup>) minimum back box volume in order to reach their full audio performance potential.

Before commencing any Studio Series installation you must be sure that the wall and ceiling positions chosen are free of obstructions such as pipe work, ducting or wiring that might interfere with the installation. Stud-finding, pipe detecting and wire detecting tools can help map the wall construction and identify any potential obstructions.

3. Speaker Positions

The appropriate positions for Studio Series speakers within the installation space will depend on their application. Position guidelines and diagrams for Studio Series in-ceiling and in-wall models are covered in the following sections and illustrated in the accompanying diagrams.

3.1 Background Audio

In-ceiling and In-wall Speakers:

If one or more Studio Series speakers are required simply to provide mono background audio, they can be located essentially as dictated by coverage, convenience and architecture. The primary acoustic constraint to consider is that corner positions are likely to result in bass emphasis.

3.2 Stereo Audio

In-ceiling Speakers:

If a pair of Studio Series in-ceiling speakers are required for stereo audio reproduction, they should ideally be located between 3 m (10 ft) and 5 m (16.5 ft) apart and a similar distance from the listening area.

In-wall Speakers:

If a pair of Studio Series in-wall speakers are required for stereo audio reproduction, they should ideally be located between 3 m (10 ft) and 5 m (16.5 ft) apart and a similar distance from the listening area. They should ideally be mounted approximately at head height when seated at the listening position or slightly higher.

**Note:** The acoustic environment around each speaker and distance from each one to adjacent walls should ideally be similar. Aim to avoid corner positions for either speaker.

3.3 Multi-channel Audio

**Note:** Studio Series in-ceiling and in-wall speakers can be combined for multi-channel audio installations. In the majority of combined installations, in-wall speakers are best suited to front (left and right) and centre channel applications, and in-ceiling speakers more suited to surround channel applications.

Diagram 3

Stereo Audio Speaker Positioning

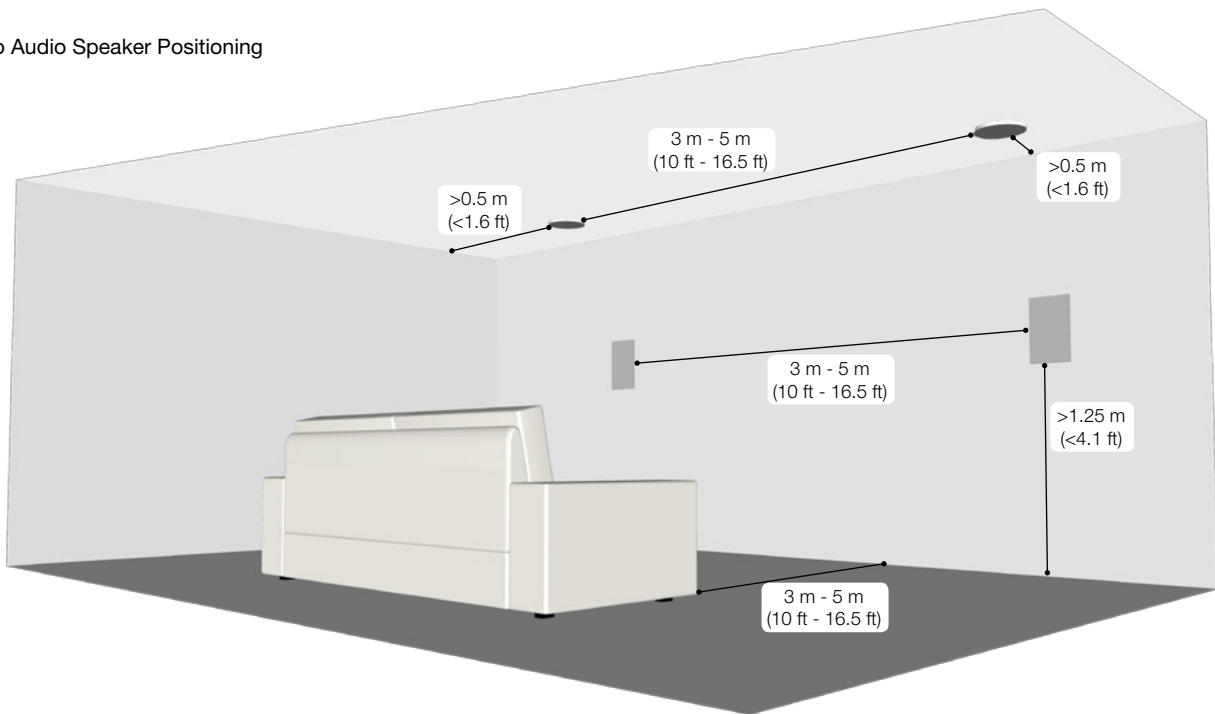

In-ceiling Speakers:

If Studio Series in-ceiling speakers are utilised in multi-channel installations, the front (left and right) and centre speakers should be located approximately 0.5 m (20 in) in front of the plane of the screen. The centre speaker should be on the centre line of the screen and the front (left and right) speakers each within approximately 0.5 m (20 in) of the sides of the screen.

In-wall Speakers:

If Studio Series in-wall speakers are utilised in multi-channel installations, the front (left and right) speakers should ideally be located either side of the screen with each one approximately 0.5 m (20 in) away. The centre channel speaker should be located either directly above or below the screen or, in the case of an acoustically transparent screen, directly behind it.

In-ceiling and In-wall Speakers:

Surround channel speakers should be located as close as possible to the requirements of the specific multi-channel format, usually just behind and at either side of the listening position. The acoustic environment around each speaker and the distance from each

Diagram 4

Multi-channel Audio Speaker Positioning

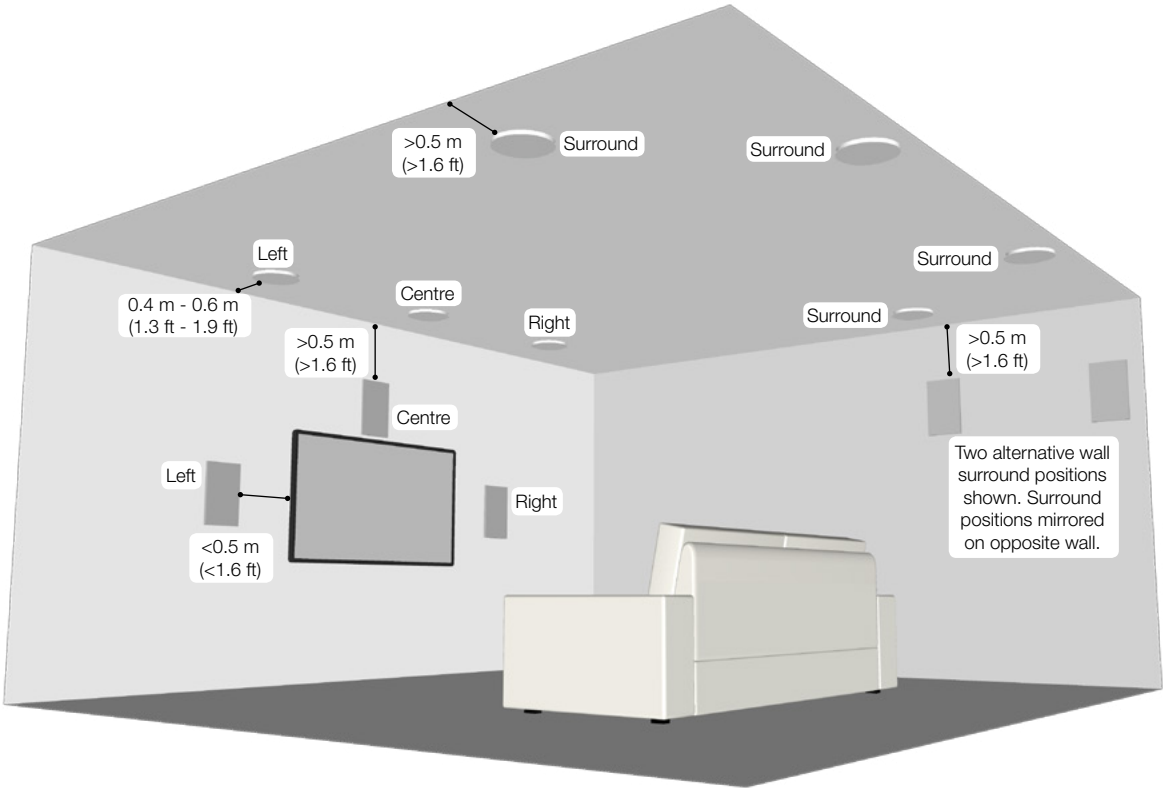

one to nearby walls should ideally be similar. Aim to avoid corner positions if possible for any speaker installation.

**Note:** The directional characteristics of Studio Series in-ceiling speakers can be optimised by rotating the Speaker Unit within its Installation Frame and adjusting the tweeter tilt. See Section 4.1 for more.

**Note:** Studio Series in-ceiling and in-wall speakers are fully appropriate for use in 5.1(2), 7.1(2), 9.1(2) multi-channel systems. Studio Series in-ceiling speakers are suitable for use in Dolby Atmos® installations.

**Note:** The nature of the installation of in-ceiling and in-wall speakers means that it is sometimes impractical to locate them in acoustically optimal positions. Compromise is often more likely to be necessary in multi-channel installations where positions have to be found for multiple speakers. In these circumstances it is preferable to favour the position of the front and centre channel speakers over that of the surround channel speakers.

## 4. In-ceiling Speaker Installation

*Note: These installation instructions broadly assume that speaker cables are pre-installed in ceilings and walls.*

To install a Studio Series in-ceiling speaker, proceed as described in the following paragraphs and accompanying diagrams:

- Having selected the installation position and checked for the presence of studs (joists), pipe work, ducts or cables, mark a cut-line on the ceiling using the supplied template. Check that the diameter of the cut-line is correct: 210 mm (8.25 in) for the S4-C65 and 260 mm (10.25 in) for the S4-C80.

- 1 Use an appropriate tool to cut along the cut-line to create a cut-out in the ceiling. Trial fit the speaker Installation Frame in the cut-out to check clearances.

**Note:** *The orientation of the Installation Frame within the cut-out is inconsequential.*

**Note:** *If using a pre-construction ring, follow the instructions in the pre-construction document.*

**Note:** *In order to reduce the possibility of audible ceiling vibration it may be prudent to apply a bead of adhesive mastic between the ceiling joists and the drywall (plasterboard) in the vicinity of in-ceiling speakers.*

- 2 With the ceiling cut-out checked, the Installation Frame can be installed. Lift the frame into place and while holding it against the ceiling with one hand use the other hand to turn the three yellow securing clamps outwards and slide them down against the inner surface of the drywall (plasterboard).
- 3

**Note:** *If speaker cables are not already installed it should be done at this stage. It is possible that access will be required through the floor above to route the cables. Use low resistance speaker cable with clear polarity marking on its insulation. Low resistance is especially important if the length of cable from amplifier to speaker exceeds 5 m. Your local Dynaudio retailer or distributor will be able to offer advice on speaker cable selection if required.*

- Pull the speaker cable through the Installation Frame and ceiling cut-out. The length of free cable should be sufficient to allow the Speaker Unit to be held in one hand while connecting the cable to the Speaker Unit terminals with the other hand.
- 4 The speaker cable can now be connected to the Speaker Unit. Strip 15 mm insulation from the cable (if necessary), twist the wire strands and insert the stripped ends into the speaker spring terminals. Ensure that the positive conductor is connected to the red speaker terminal and the negative conductor is connected to the black speaker terminal.

- 5 With the Speaker Unit connected to the speaker cable the unit can be lifted up into the Installation Frame. Turn the locking tabs on the front surface of the Speaker Unit fully clockwise (aligned with the lock icons) and insert it into the Installation Frame. Push gently around each locking tab until a click is heard. The Speaker Unit will then be secure in the frame.

**Note:** *Take care that the speaker cable is positioned in such a way that it will not get trapped as the Speaker Unit is secured into the Installation Frame and is not touching the Speaker Unit in such a manner that it is likely to result in audible vibrations.*

**Note:** *To remove the Speaker Unit from the Installation Frame turn the locking tabs 90° counter-clockwise. Take care to support the speaker as the locking tabs are released.*

- 5 With the speaker connected and secured into the Installation Frame, its bass/mid driver orientation and tweeter angle can be adjusted. In most installations, the orientation and angle should be adjusted so that the drivers face towards the listening position. To adjust the bass/mid driver orientation, grip the tweeter mounting arm and rotate the entire Speaker Unit as necessary. To adjust the tweeter tilt, grip the tweeter body and angle it to one of the three positions.

- 5 The high frequency tonal balance of Studio Series speakers can be adjusted to suit different installation environments. A tweeter level switch located on the Speaker Unit front panel offers +3 dB, 0 dB and -3 dB options.

**Note:** *The +3 dB tweeter level option may be appropriate if, for example, carpets, soft furnishings and curtains dominate in the listening environment. Alternatively the -3 dB option may be more suited to an environment where hard floors and glass predominate. In more balanced acoustic environments the 0 dB option is likely to be most appropriate.*

- In-ceiling speaker installation is completed by fitting the grille. The grille is secured magnetically and requires no more than placing into position.

**Note:** *Square Studio Series in-ceiling speaker grilles are optionally available. Magnetic attachment enables square grilles to be rotated as required to align perfectly with ceiling or wall lines.*

**Note:** *If the ceiling is to be painted following speaker installation, the supplied paint mask must be used to protect the speaker hardware from paint ingress. Speaker grilles should not be fitted during painting. They should be painted separately.*

Diagram 5 illustrates the in-ceiling speaker installation procedure.



Diagram 5

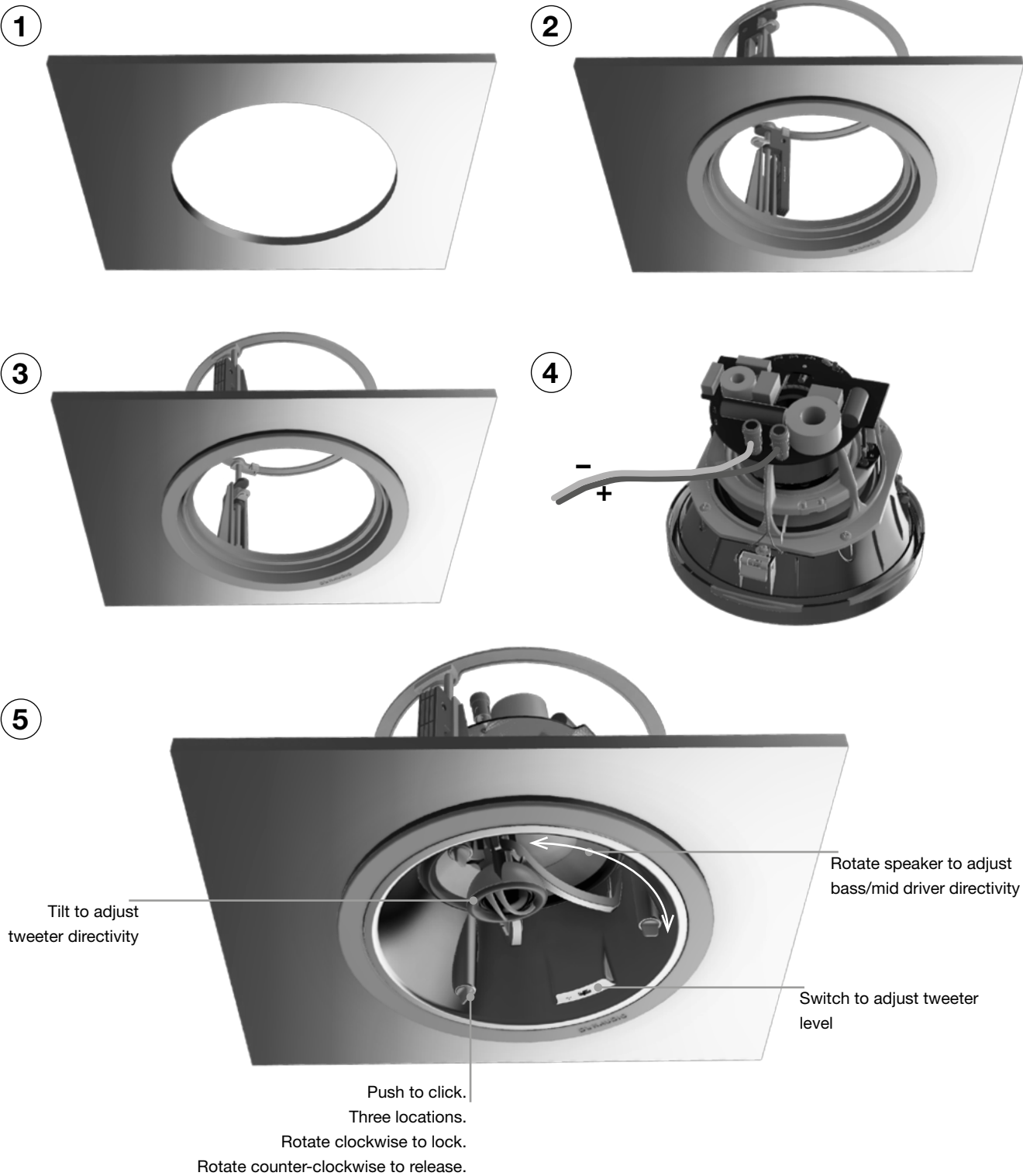

## 5. In-wall Speaker Installation

To install a Studio Series in-wall speaker, proceed as described in the following paragraphs and accompanying diagrams:

- Having selected the installation position and checked for the presence of studs (joists), pipe work, ducts or cables, mark a portrait orientation cut-line on the wall using the supplied template. Check that the dimensions of the cut-line are correct: 175 mm x 275 mm (6.90 in x 10.83 in) for the S4-W65 and 215 mm x 370 mm (8.25 in x 14.38 in) for the S4-W80.

**Note:** Studio Series in-wall speakers are intended to be used in portrait orientation.

- 1 Use an appropriate tool to cut along the cut-line to create a cut-out in the wall. Trial fit the speaker Installation Frame in the cut-out to check clearances.

**Note:** In order to reduce the possibility of audible wall vibration it may be prudent to apply a bead of adhesive mastic between the wall studs and the drywall (plasterboard) in the vicinity of wall speakers.

- 2 With the cut-out checked, the Installation Frame can be installed. Insert the frame into place and while holding it against the wall with one hand use the other hand to turn and slide the four yellow securing clamps outwards and slide them down against the inner surface of the drywall (plasterboard).
- 3

**Note:** If speaker cables are not already installed it should be done at this stage. It is possible that access will be required through the opposite side of the wall to route the cables. Use low resistance speaker cable with clear polarity marking on its insulation. Low resistance is especially important if the length of cable from amplifier to speaker exceeds 5 m. Your local Dynaudio retailer or distributor will be able to offer advice on speaker cable selection if required.

- Pull the speaker cable through the Installation Frame and wall cut-out. The length of free cable should be sufficient to allow the Speaker Unit to be held in one hand while connecting the cable to the Speaker Unit terminals with the other hand.
- 4 The speaker cable can now be connected to the speaker. Strip 15 mm insulation from the cable (if necessary), twist the wire strands and insert the stripped ends into the speaker spring terminals. Ensure that the positive conductor is connected to the red speaker terminal and the negative

conductor is connected to the black speaker terminal.

- 5 With the Speaker Unit connected to the speaker cable it can be inserted into the Installation Frame. Turn the locking tabs on the front surface of the Speaker Unit fully clockwise (aligned with the lock icons) and insert it in the Installation Frame. Push gently around each locking tab until a click is heard. The Speaker Unit will then be secured in the frame.

**Note:** Take care that the cable is positioned in such a way that it will not get trapped as the Speaker Unit is secured into the Installation Frame and is not touching the Speaker Unit in such a manner that it is likely to result in audible vibrations.

**Note:** To remove the Speaker Unit from the Installation Frame turn the locking tabs 90° counter-clockwise. Take care to support the speaker as the locking tabs are turned.

**Note:** Studio Series wall speakers are intended to be installed with the tweeter above the bass/mid driver.

- 5 The high frequency tonal balance of the Studio Series speakers can be adjusted to suit different installation environments. A tweeter level switch located on the Speaker Unit front panel offers +3 dB, 0 dB and -3 dB options. The level adjustment operates from approximately 3 kHz upwards.

**Note:** The +3 dB tweeter level option may be appropriate if, for example, carpets, soft furnishings and curtains dominate in the listening environment. Alternatively the -3 dB option may be more suited to an environment where hard floors and glass predominate. In more balanced acoustic environments, the 0 dB option is likely to be most appropriate.

- With the speaker connected and secured into the Installation Frame, in-wall speaker installation is completed by fitting the grille. The grille is secured magnetically and requires no more than placing into position.

**Note:** If the wall is to be painted following speaker installation, the supplied paint mask must be used to protect the speaker hardware from paint ingress. Speaker grilles should not be fitted during painting. They should be painted separately.

Diagram 6 illustrates the in-wall speaker installation procedure.

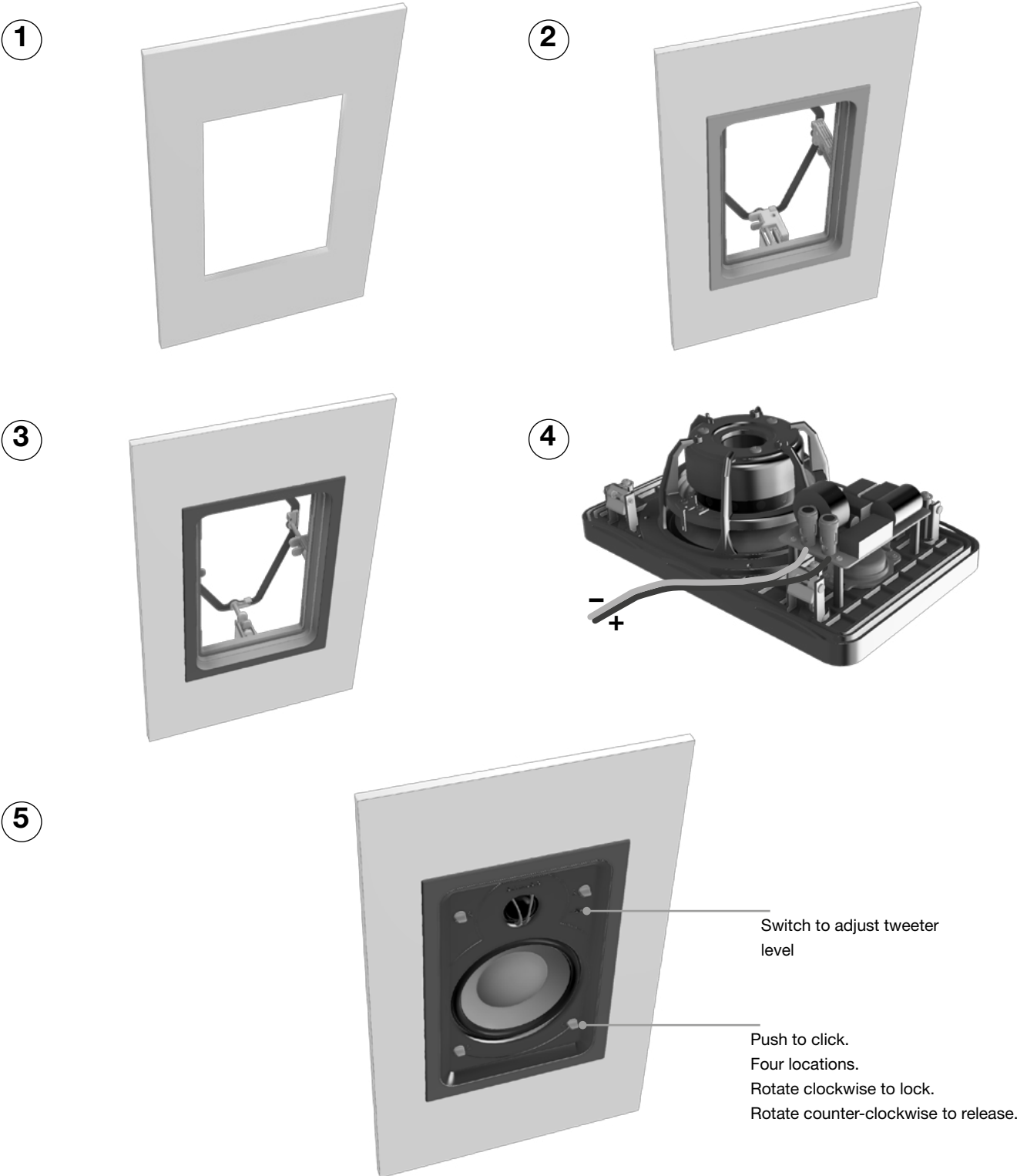

# SPECIFICATIONS

## STUDIO SERIES

Data	S4-C65	S4-C80	S4-W65	S4-W80
Type	2-way in-ceiling	2-way in-ceiling	2-way in-wall	2-way in-wall
Drivers	Tweeter: 25 mm (1 in)	Tweeter: 25 mm (1 in)	Tweeter: 25 mm (1 in)	Tweeter: 25 mm (1 in)
	Bass/mid: 165 mm (6.5 in)	Bass/mid: 200 mm (8.0 in)	Bass/mid: 165 mm (6.5 in)	Bass/mid: 200 mm (8.0 in)
Frequency response	55 Hz – 20 kHz ±3 dB	45 Hz – 20 kHz ±3 dB	55 Hz – 20 kHz ±3 dB	45 Hz – 20 kHz ±3 dB
Impedance	8Ω nominal	8Ω nominal	8Ω nominal	8Ω nominal
	5Ω minimum	5Ω minimum	5Ω minimum	5Ω minimum
Sensitivity	87.5 dB @ 1 m, 2.83V	89.0 dB @ 1 m, 2.83V	87.5 dB @ 1 m, 2.83V	89.0 dB @ 1 m, 2.83V
Power handling	50 W	100 W	50 W	100 W
Tweeter level options	-3 dB, 0 dB +3 dB	-3 dB, 0 dB +3 dB	-3 dB, 0 dB +3 dB	-3 dB, 0 dB +3 dB
Tweeter orientation	Three tilt angles	Three tilt angles	N/A	N/A
Bass/mid orientation	18° x 360°	18° x 360°	N/A	N/A
Dimensions/Depth	Ø 231.5 mm / 151.5 mm	Ø 280.0 mm / 160.5 mm	197.5 x 296.3 mm /	236.5 x 391.5 mm /
	Ø 9.11 in / 6.0 in	Ø 11.0 in / 6.33 in	89 mm	95.5 mm
Cut-out dimensions	Ø 210 mm	Ø 260 mm	175 x 275 mm	215 x 370 mm
	8.25 in	10.25 in	6.90 x 10.83 in	8.25 x 14.28 in
Grille material	Painted steel	Painted steel	Painted steel	Painted steel
Grille options	Round/square	Round/square	Rectangular	Rectangular
Grille attachment	Magnetic	Magnetic	Magnetic	Magnetic
Grille finish	Paintable	Paintable	Paintable	Paintable
Certifications	CE	CE	CE	CE
Environmental	RoHS	RoHS	RoHS	RoHS

DYNAUDIO